

VER	DESCRIPTION OF REVISIONS	DATE
A-0		2021/07/29
A-1	Door track change to S22-207	2023/10/23
A-2	Fan motor change to S17-223 Fan blade change to S17-224	2023/12/20
A-3	Fan change to S17-232	2023/12/29

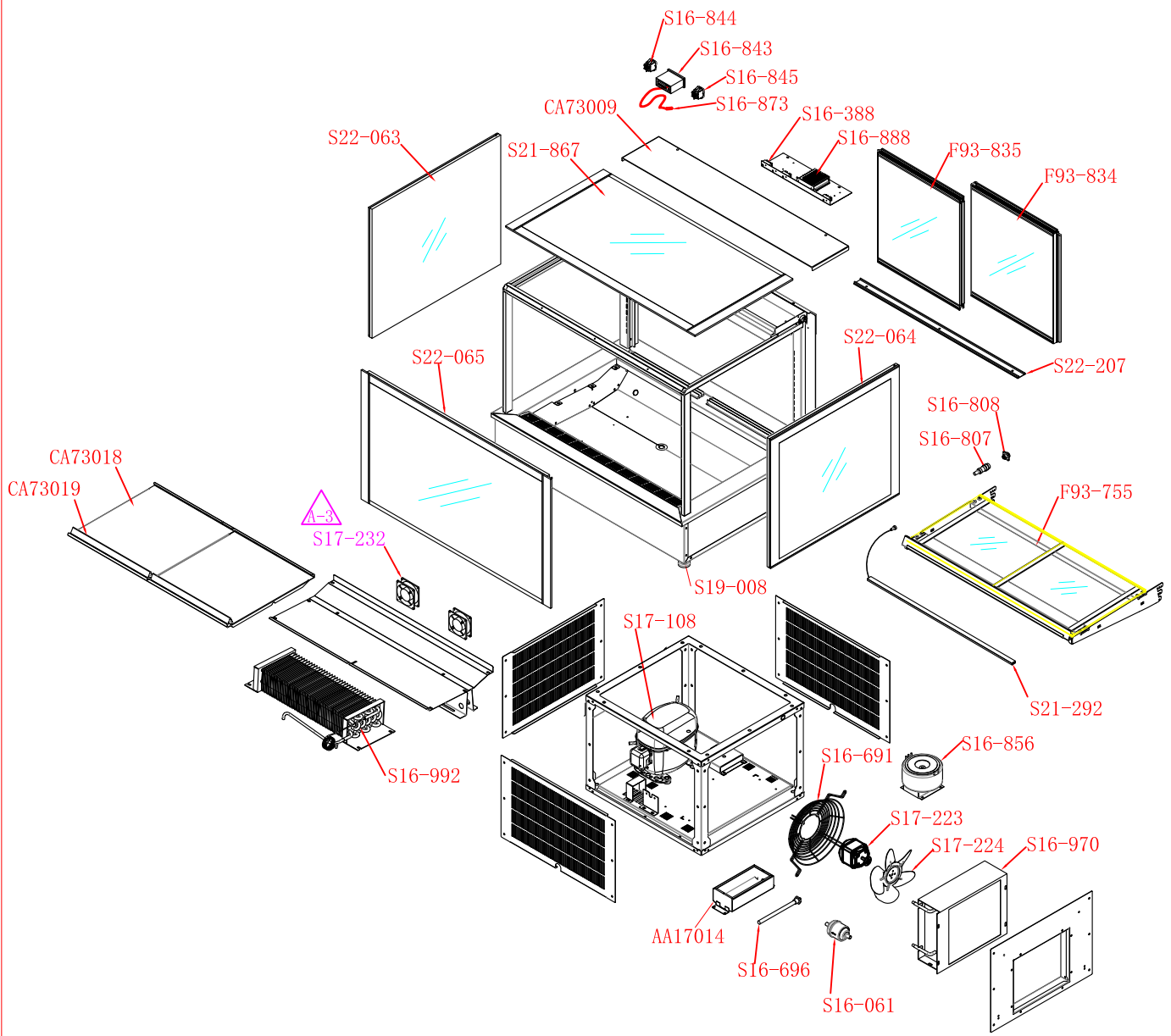

Cossiga F93-204 GGRF9R						
No	Part No	Name	Spec	Unit	QTY	Note
1	CA73009	Top cover		PCS	1	
2	AA17014	Evaporating pan with heater		PCS	1	
3	CA73018	Deck trays		PCS	2	
4	CA73019	Ticket strips of deck		PCS	2	
5	S16-970	Condenser	350x288x122, Φ7	PCS	1	
6	S16-061	Filter	DML-053S-3/8"	PCS	1	
7	S16-388	Terminal block	250VAC, 2.5MM2	PCS	3	
8	S17-223	Fan motor	M40Q45-EF01-01/A37, 34W	PCS	1	
9	S17-224	Fan blade	Φ254mm	PCS	1	
10	S16-691	Fan housing of motor	Φ280-80	PCS	1	
11	S16-696	Heater	190W	PCS	1	
12	S16-807	Plug	WS16J3TQ-C, WE1PU, 3P	PCS	1	
13	S16-808	Socket	WS16K3Z-C, WE1PU, 3P	PCS	2	
14	S16-843	Thermostat	Dixell XR06CX-5NOC1 240V/50HZ	PCS	1	
15	S16-844	Power supply button	R-1-210-C5L-BR, Green	PCS	1	
16	S16-845	Lamp button	R-1-210-C5L-BG, Yellow	PCS	1	
17	S16-856	Transformer	KT120-0400-1-01 240V-36V	PCS	1	
18	S16-873	Sensor	Dixell NG6 3M	PCS	1	
19	S16-888	Power supply	LRS-75-12, 12V/6A	PCS	1	
20	S16-992	Evaporator	O.D. 95X400X175 (Φ9.52)	PCS	1	
21	S17-108	Compressor	SECOF, SC15MNX/R290	PCS	1	
22	S17-232	Fan	CROWN, ECD08025B2H 1P68	PCS	2	
23	S19-008	Plastic footing	M10*55	PCS	4	
24	S22-207	Door track		PCS	1	
25	S21-292	LED light	L=700	PCS	2	
26	S22-063	Heated side glass - Left		PCS	1	
27	S22-064	Heated side glass - Right		PCS	1	
28	S21-867	Top glass		PCS	1	
29	S22-065	Front glass		PCS	1	
30	F93-755	Shelf assy		PCS	1	
31	F93-834	Rear Sliding Door - Left		PCS	1	
32	F93-835	Rear Sliding Door - Right		PCS	1	